



LOPPA

THE FINNMARK ALPS

biotope
ARCHITECTURE & NATURE

Destination Development Concept 2019



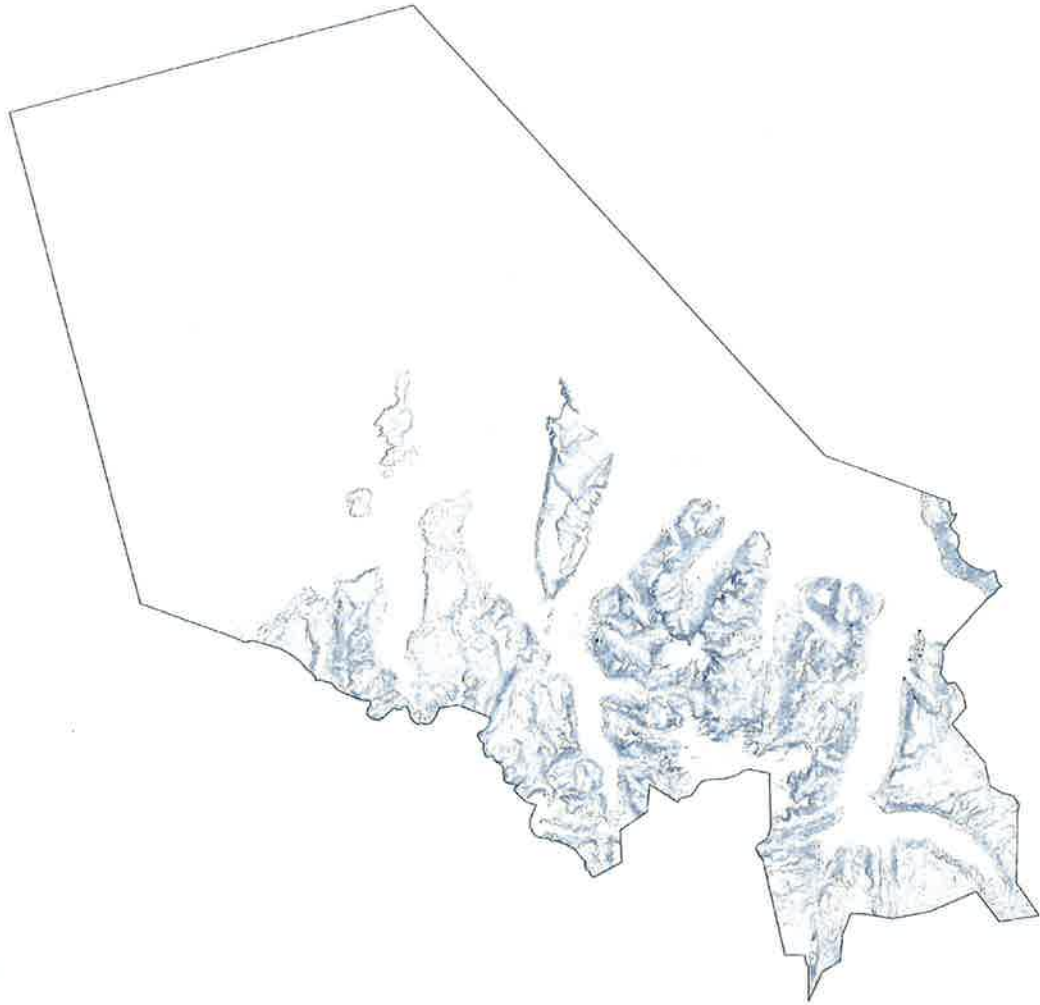

LOPPA KOMMUNE

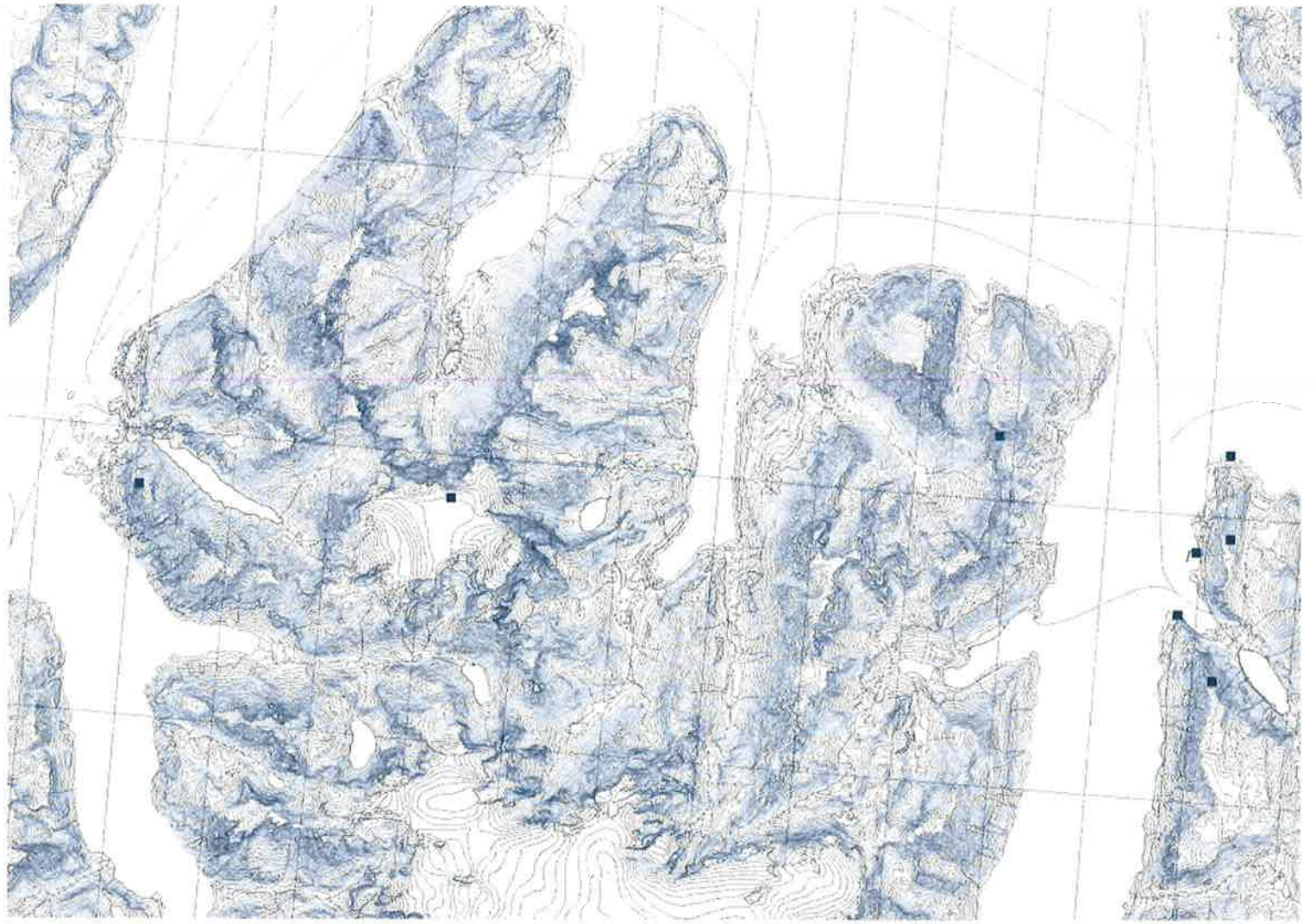

BRATT FRILUFTSLIV

WHAT

Loppa's unique combination of Fjords and Mountains mean that it has a lot to offer in terms of outdoor activities. Specialized tourism, such as mountain hiking, nature photography, northern lights, skiing and scooter trips all hold great potential for the area.

In order to accommodate this kind of nature tourism, specific infrastructure is required. Identifying and developing key areas, marketing and promoting these areas as well as highlighting additional attractions is a central aspect of the development.

Nature enthusiasts are looking for facilities and services that can enhance their experience of the area, provide more comfortable conditions to carry out their interests and offer good experiences. Quality rather than quantity is the goal, you do not need a lot of products to attract, however the products that you do offer must be of high quality, relevant and provide memorable experiences.

This document outlines a destination development plan with focus on accentuating these qualities through architectural intervention, and making Loppa a premium destination for outdoor activities, with international attention.



BRATT FRILUFTSLIV

WHY

With abundant nature and spectacular scenery, Loppa is a world-class destination. There is a vast amount of untapped potential in the region. If this is managed correctly, tourism could provide Loppa with a sustainable and renewable source of income.

Facilities are not just meaningful for visitors, as locals are also a key focus of the projects. Their needs and wants are as much of a priority during the design process. The project should foster a sense of community and pride, alongside a clearer branding for the region, as well as improving conditions of local outdoor life and public health.

Walking and hiking are important recreational activities for European tourists, according to a survey by the English tourist board 80% of tourists go on walks during their holiday. In winter resorts such as Austria, Switzerland and Germany they have reported an increase in tourists taking walks on snow covered trails.

"It is important to remember when developing a hiking product that tourists "consume" more than just a foot-path. They're interested in the whole area: its scenery and regional identity, its different routes and services: before, during and after the walk."

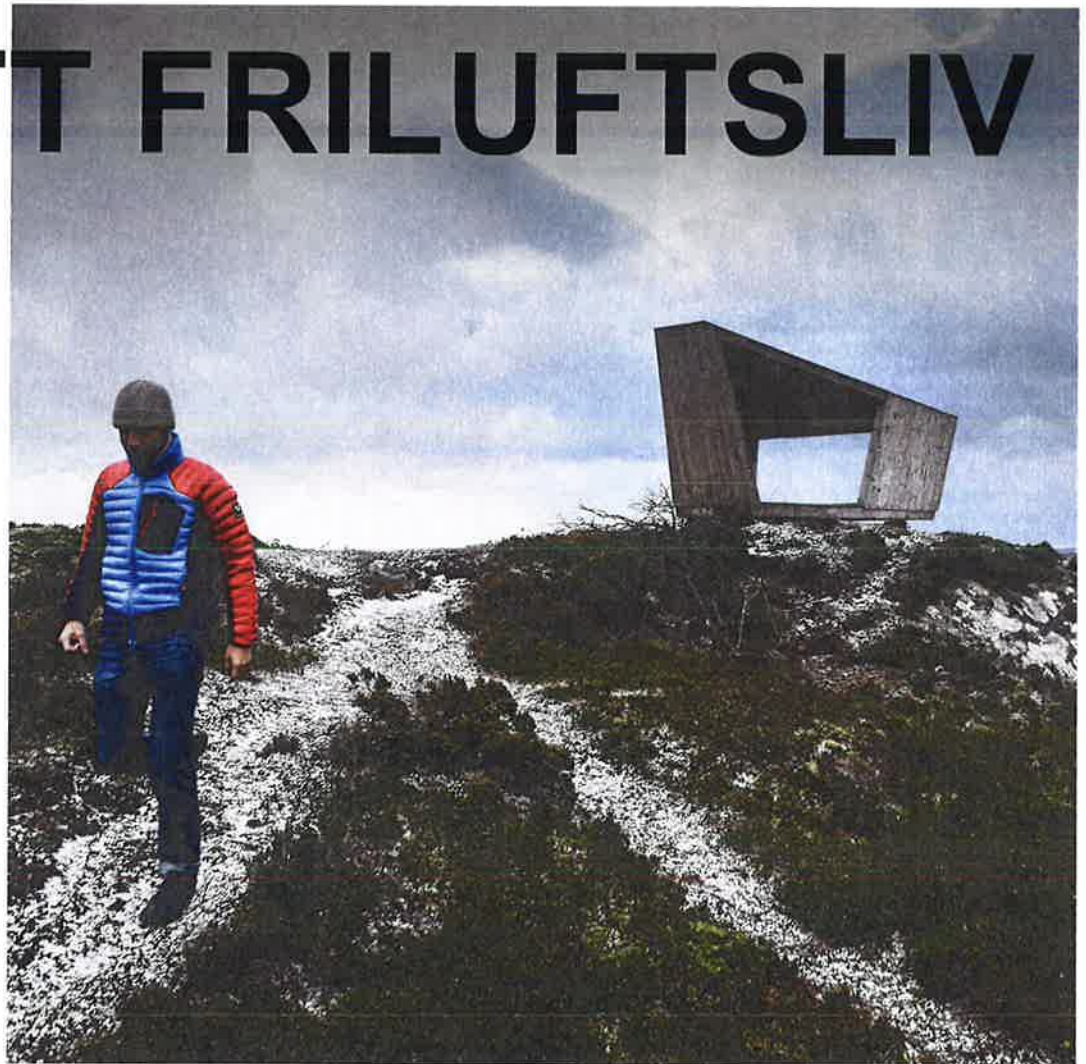

BRATT FRILUFTSLIV

HOW

Biotope is Norway's first and only architectural office, with special expertise in nature based tourism destination development. Our architectural solutions are built on both understanding and care for nature.

Biotope have undertaken several destination development projects in Norway, Iceland and the UK, and have provided consultation to many private actors and public communities wishing to develop unique nature based products that target the nature based market. It is with this extensive experience and expertise within this field that Biotope have development this feasibility study for Loppa. Biotope have developed a series of concepts and sketch designs of 8 architectural projects.

These projects will range from bivouacs to wind shelters, and will help to define key hiking routes and improve available experiences.

Workshops and conversations with locals, community officials and other key actors is an essential part of the process. We would like to thank all people involved in the process. They are too many to thanks individually, as many are representatives of larger interest groups and as such this is a project undertaken to support and develop the Loppa community as a whole.



BRATT FRILUFTSLIV

WHERE

8 locations will be chosen to host the architectural layouts. Through research during a thorough site visit and a workshop with locals, these were selected.

Each location is chosen not only for individual qualities, but also for its role within a larger sequence, or collection, of locations.

A variation in walks or hikes in an area is important to meet the needs of nature tourists. Circular walks, day walks, long walks and overnight walks with multiple stopping points and the option of transfers and pick ups are all ingredients for a successful hiking area. The area is the main selling feature, as hikers are looking for diversity in landscape, natural heritage, local traditions, scenery and nature. They are motivated by unspoilt nature, wellbeing, discovery and the availability of marked footpaths and trails.

All of these things were considered when selecting the 8 sites for intervention. The result is three families of gapahuks, spread across two key points in Loppa. Together, these 8 layouts will offer locals and visitors a coherent foundation for experiencing everything Loppa has to offer. Highlighting the region's best hiking routes and most spectacular views.

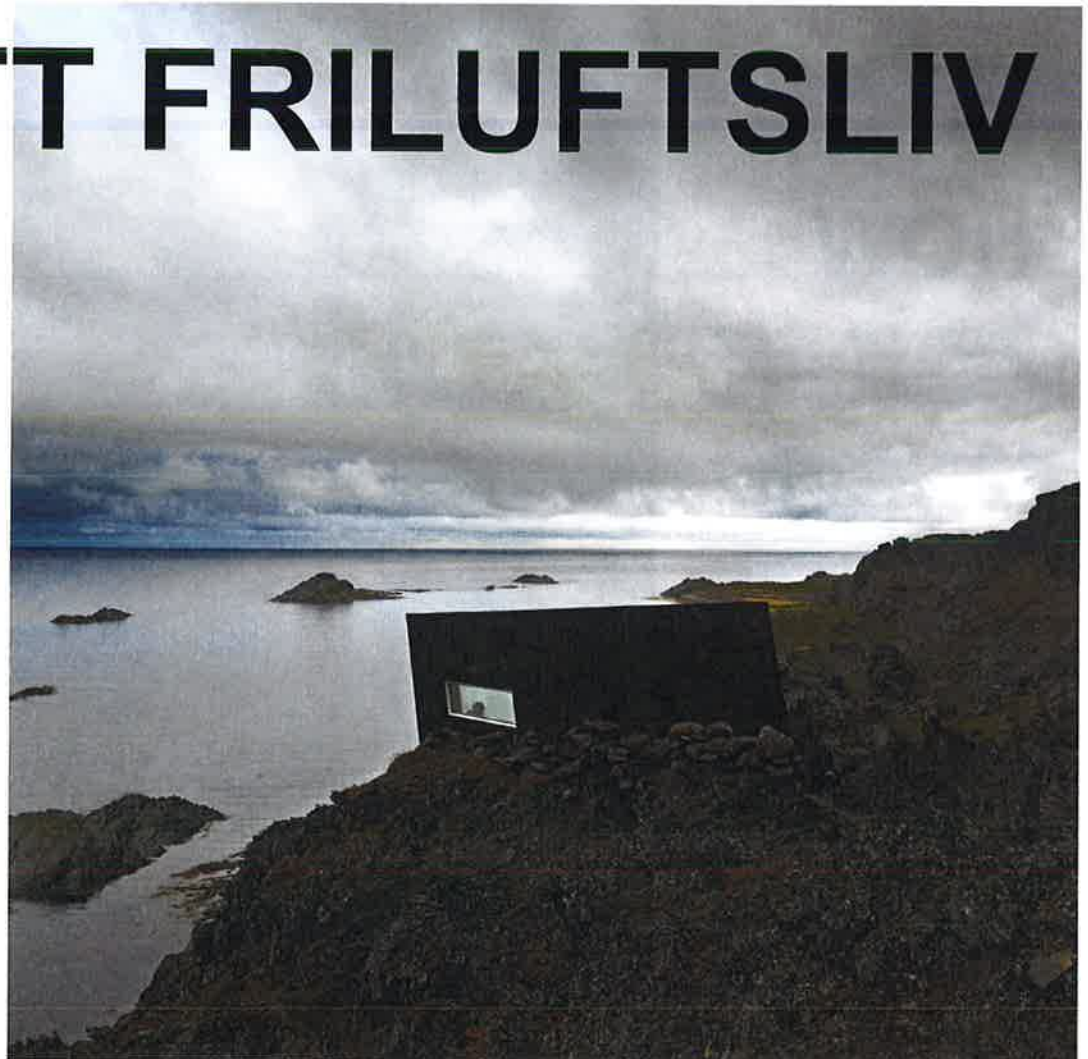

biotope

ARCHITECTURE & NATURE

Destination development schemes and feasibility studies is a key part of Biotope's work. As an architectural practice we are well known for our small scale pieces of architecture designed to connect people with nature. However Biotope is in many ways a destination developer. Through extensive site visits, on site work and workshops, we develop and create large scale projects aiming to promote nature based destinations and niche ecotourism projects.

The Loppa community feasibility study is such a project, where we have sought to find the most inspiring sites and design small scale architectural interventions

that will highlight the qualities of each site. The aim is as always to connect people with nature through architecture. We hope Loppa and the increasingly famous 'Finmark Alps' though these projects will gain more international attention, as well as increased local awareness and excitement!

The following pages show some examples of destination schemes and feasibility studies by Biotope. Both Varanger and Smøla have become increasingly famous nature destinations, with an international audience.

The Biotope bivouac or wind shelters concepts (gapahuk in norwegian) are developed in Arctic Norway and tested in the most extreme conditions. Durability, wind stability, minimal maintenance are important. They are designed to be affordable, yet elegant little buildings. A key character of the Biotope design is an open and inviting architecture aimed at connecting people with nature

SMØLA
NATURRESERVAT
LANDSKAPSVERNOMRÅDE
VEI

- 1 - Stormhytte (Veihome)
- 2 - Mobilt flytende fotoskjul (+ørne-fotoskjul)
- 3 - Gapahuk 1 (Monsøysvaet)
- 4 - Sti / klopp (Måbergtua)
- 5 - Gapahuk 2 (Svanøya)
- 6 - Fugletårn / utkikkingsplattform (Toppmyra)
- 7 - Fugletårn / friluftsamfi (Fløjtjønn)

1 - Stormhytte (Veihome)
Veihome er Smølas nordlige ytterpunkt, og et populært turmål. Dette er en av de beste plassene for å oppleve skikkelig uvær. Innenfor moloen foreslås en stormhytte, både for sjøfugl-kikking og uværopplevelser.

2 - Mobilt flytende fotoskjul (+ørne-fotoskjul)
Smøla har potensiale for å bli en destinasjon i verdensklasse for fugletogreføring. For å oppnå dette kreves unike fotoskjul og lokale aktere med spisskompetanse på temålet.

3 - Gapahuk 1 (Monsøysvaet)
Smøla har en unik skjærgård med mange holmer. Med en serie gapahuker kan man skape gode le- og rasteplasser for kajakkpadlere og folk på tur i båt. Dette blir små turmål for de som opplever Smøla fra sjøen.

4 - Sti / klopp (Måbergtua)
Enhver destinasjon med respekt for seg selv har toppturer. Måbergtua er en av Smølas høydepunkter. Herfra har man utsikt / oversikt over Norges største lavlandsleite. Stien frem må oppgraderes for å bli en god attraksjon.

5 - Gapahuk 2 (Svanøya)
I plasseringen av gode le- og rasteplasser søker man samarbeid med lokale reiselivsaktører. Både ved gapahuk 1 og 2 har man lokale aktere i nærheten som både kan benytte gapahukene, samt bidra med oppsyn. Gapahuk 1 og 2 er en type moderne gapahuker, men begge med litt ulik utforming og funksjonalitet.

6 - Fugletårn / utkikkingsplattform (Toppmyra)
Smølas myr- og stettelandskap er en unik naturtype. I overgangen mellom dyrket mark, myr og småvann finnes det mye fugler. Inne på Smøla ligger Toppmyra som er en svært god fuglelokalitet. Herfra kan man oppleve rovfugler på næringsek, men det er et behov for en god utkikkpost / samlingsplass for besøkende.

7 - Fugletårn / friluftsamfi (Fløjtjønn)
Fløjtjønn er en av Smølas beste fuglelokaliteter. Her finnes det alltid fugler, og ofte med et godt artsutvalg. Her foreslås anlagt et kombinert fugletårn og friluftsamfi, tilpasset både turgrupper og skoleklasser (friluftsunndervisning).

SMØLA

mulighetsstudie

Tilrettelegging for naturbasert reiseliv og friluftsliv

For
Smøla Nærings- og
kultursenter KF

av
Biotope AS
arkitektur & natur

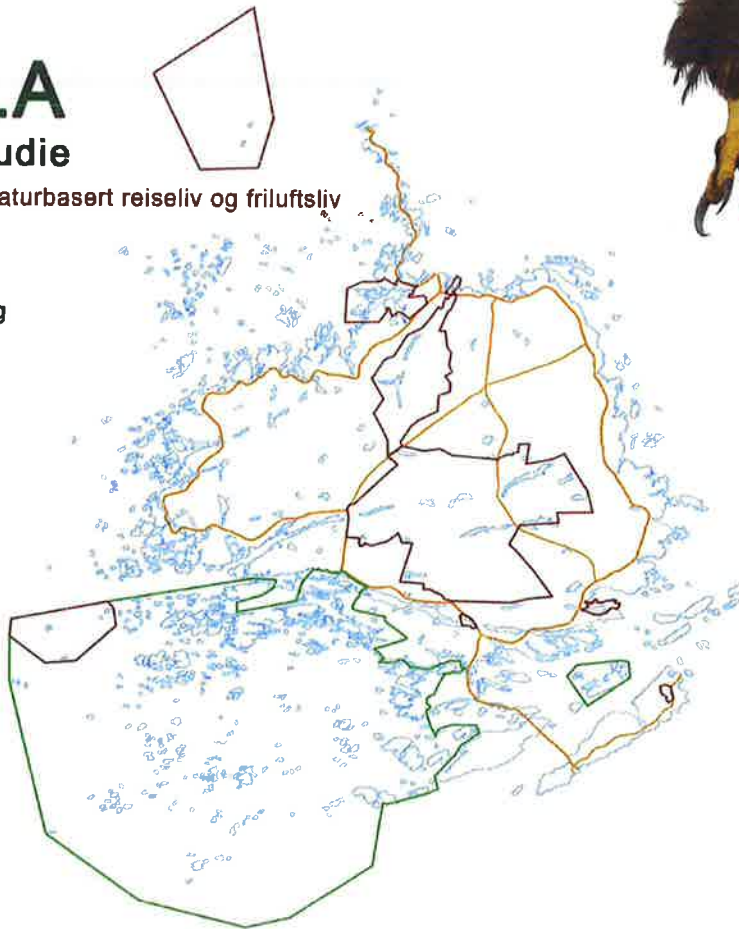

SAMPLE DESTINATION DEVELOPMENTS

BIRDING DESTINATION
VARANGER
 ARCTIC NORWAY



Varanger is the world's easiest accessible arctic birding destination. In Varanger, you can experience the northern taiga, tundra and the arctic coastline within a day's drive. You can enjoy an amazingly rich birdlife in stunning scenarios. Varanger is famous for its wintering population of Steller's Eiders. However, the wide variety of unique bird species have made Varanger one of the top birding destinations of the world.



Experience the King Eider vortex in Bussasundet, south of Varanger, where up to 15000 King Eiders can be seen wintering with 12,500 Common Eiders and hundreds of Steller's Eider and Long tailed ducks.



The King Eider is the most striking bird of the Arctic and can be found all year. During winter and spring Båtsfjord harbour is the best place to get up close and personal with King Eiders.

VARANGER ARCTIC NORWAY

- Wind shelter / Bird hide
- Bird cliff
- Seawatching point
- Main road
- Summer road only (open from 1st May)

Locations marked on map: SLETTNES, MEHAIN, NORDKYN PENINSULA, BERLEVÅG, KONGSFJORD, BÅTSFJORD, ØEDNUR, SYLTFJORD, HAMNINGBERG, HORNNØYA, ULDVARDEN, KJØBERG, KOMAGVÆR, SKALLELV, VARANGERFJORD, TANA BRU, VARANGERDØTTEN, NESSEBY, VESTRE JAROBSELV, VADLØ, EKKERBY, NEDEN, KØRKENES, PASVIK, SVANVIK, MELKEFOSS, NYRUD.

North Norway (1600-1800) - 1600-1800

North Norway is official Tourist Portal. Everything travel related: www.northernorway.com/en

birding portal

The latest bird news from Finnmark county (Varanger): www.twitter.com/finnmarkbirding, [twitter: @finnmarkbirding](https://twitter.com/finnmarkbirding)

biotope www.biotope.no

Biotopo is a pro nature architectural practise, based in Varanger. Biotopo has been working for several years with the development of Varanger as a birding destination. In collaboration with our partners in Varanger, we have now placed several bird hides and shelters at key birding sights in the region. You will also find a lot of inspirational info on birding in Varanger at www.biotope.no

Welcome to Varanger!



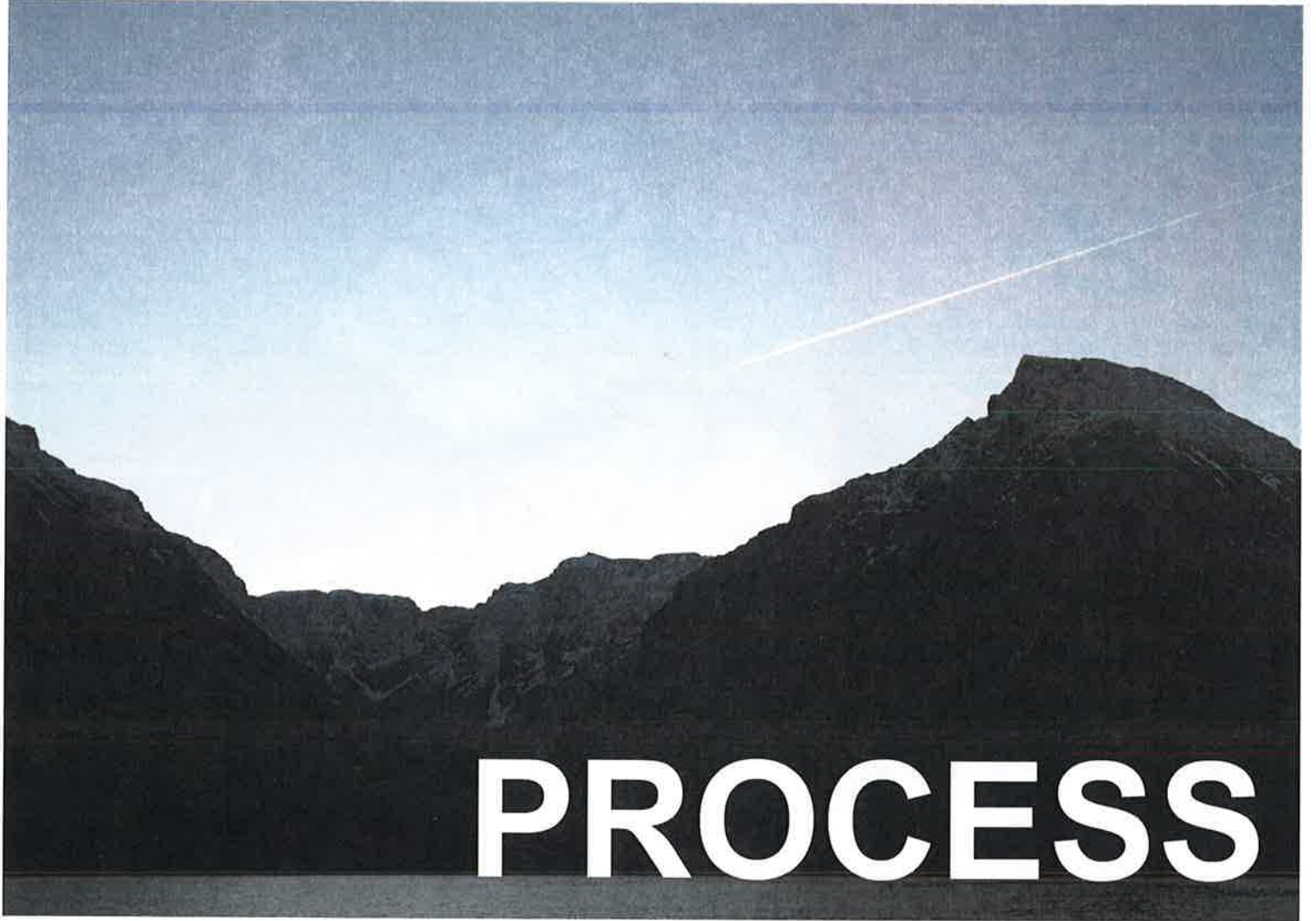

PROCESS

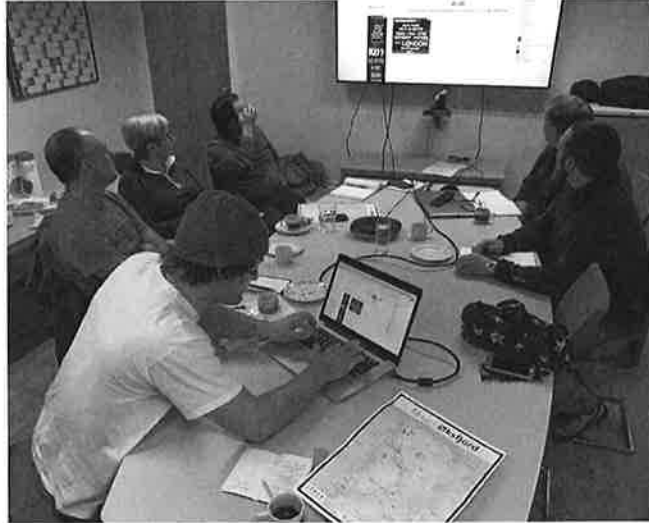



CONCEPT

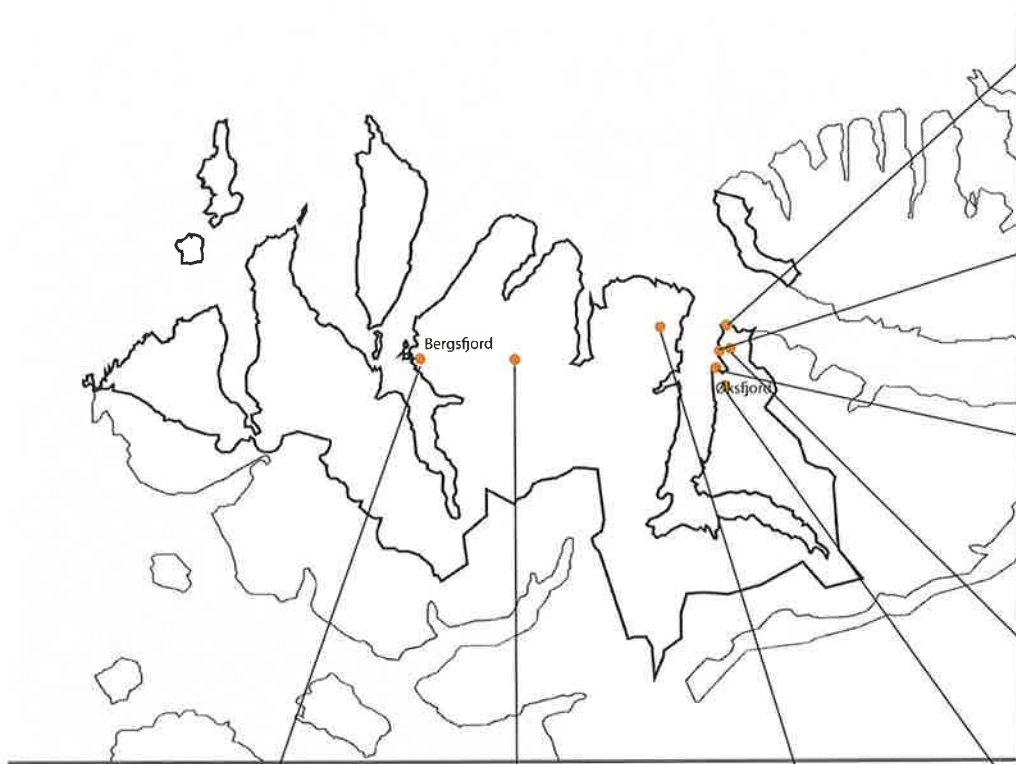

**KOLLAREN
GAPAHUK**

Kollaren summit wind shelter



**THE GLACIER BASE
STATION**

Ultimate isolation glacier top bivouac

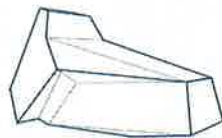

**THE RIDGE
BIVOUAC**

Halfway point of an iconic ridge hike

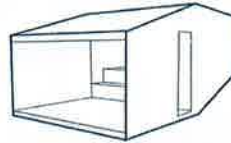

**NORTHPOINT
WINDSHELTER**

The northernmost point in Øksfjord

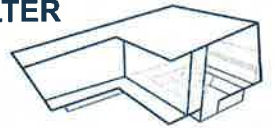

**BREAKWATER
WINDSHELTER**

A central gathering point, closest to Øksfjord centre

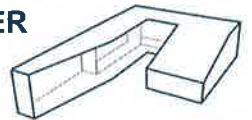

**WELCOME
WINDSHELTER**

The point visitors will turn a bend and see Øksfjord for the first time

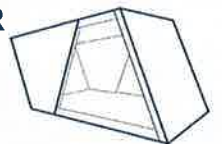

**ØKSFJORD-
FJELLET
BIVOUAC**

Mountain top wind shelter with views over Øksfjord

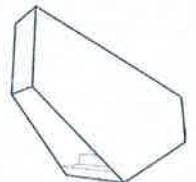

**VASSDALS
BIVOUAC**

Vassdals summit overlooking surrounding mountains and fjords





ØKSFJORD



INTRODUCTION

As the municipal centre, Øksfjord is a critical point in the region. As the most accessible town within Loppa, it is an ideal base point for tourist activities. It offers comforts that travellers might seek, such as wifi, showers, hot food and a place to warm up. At the same time, it is nestled in a spectacular environment, that offers the opportunity to escape into the wilderness.

From this point a diversity of activities are offered. Two families of gapahuks focus on two different kinds of experiences for visitors and locals.

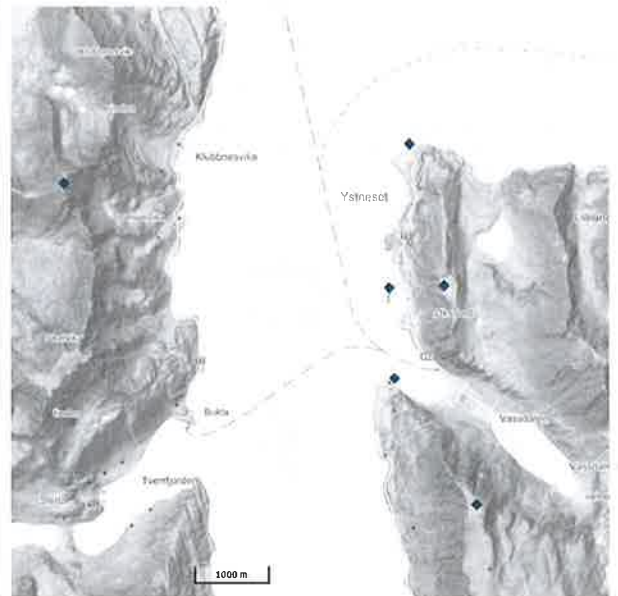



FJORD GAPAHUKS

This family of gapahuks is unique because of its accessibility. Without any need to hike, these sites are ideal for young families or elderly nature lovers, as well as locals which are looking for an outdoor experience close to the center of Øksfjord.

These three gapahuks offer refuge from the wind and rain, and are ideal spots for picnics, scenic photography, and even overnighting. All have impressive views over the fjord.

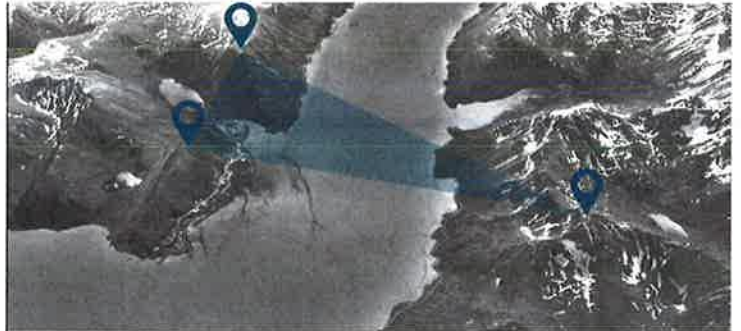

MOUNTAIN BIVOUACS

This family is a simpler collection of shelters for more hardcore hikers. Carefully positioned, each gapahuk offers breathtaking views over the surrounding landscape, with Øksfjord always in sight. Strategically positioned they are integral parts (peaks or half way points) of the area's hiking routes which are believed to have the most potential.

The isolation and dramatic positioning of these gapahuks offer spectacular ways to experience the northern lights or the midnight sun.



Øksfjord area hiking map



1 Øksfjordfjellet

Perletur route
summit 370m
easy & popular
directly accesible from Øksfjord

2 Vassdalstinden

Perletur route
summit 678m
difficult
directly accesible from Øksfjord

3 Sommersettinden

summit 836m
difficult
boat transfer services necessary

FJORDS 1: THE WELCOME WINDSHELTER

First impressions matter; located at a critical corner, this Gapahuk will stand where visitors first see Øksfjord.

After turning the corner, the village is suddenly visible. Visitors will be able to park next to the site and picnic with panoramic views over Øksfjord and the surrounding

mountains, sheltered from wind and rain.

An iconic structure will make this moment even more memorable. Space for a large information board is also created, ideal for an introductory experience to the area.

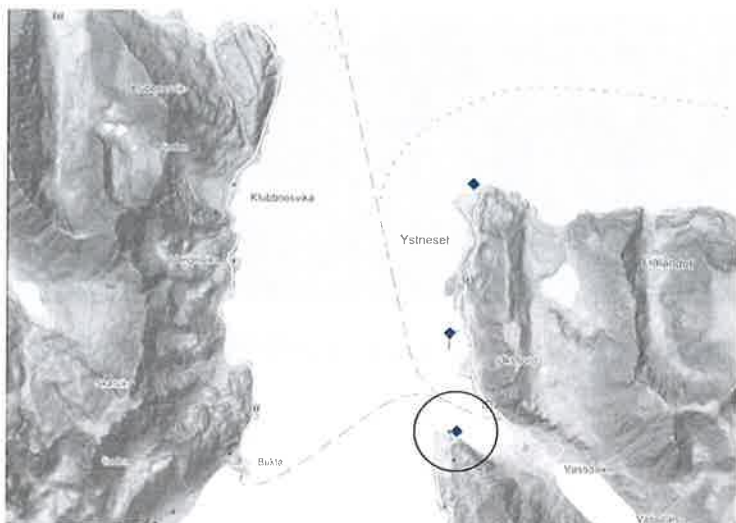
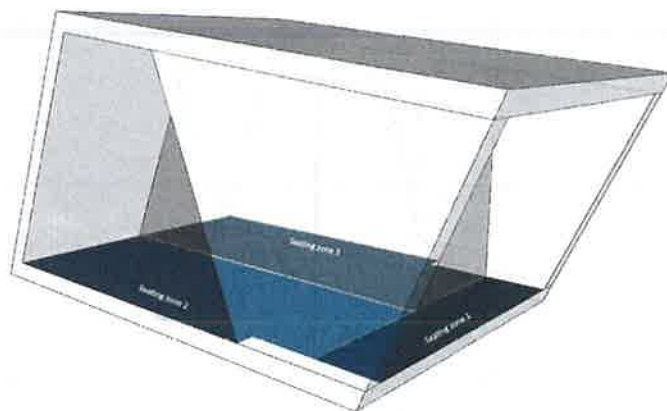



view towards Øksfjord from project site

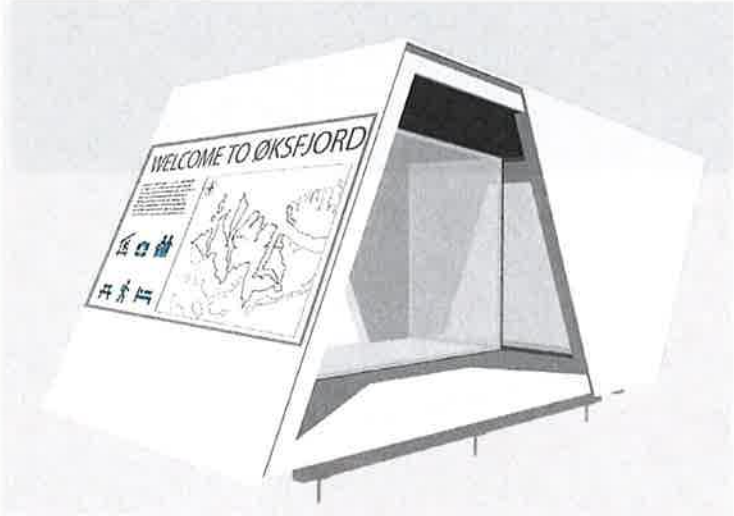
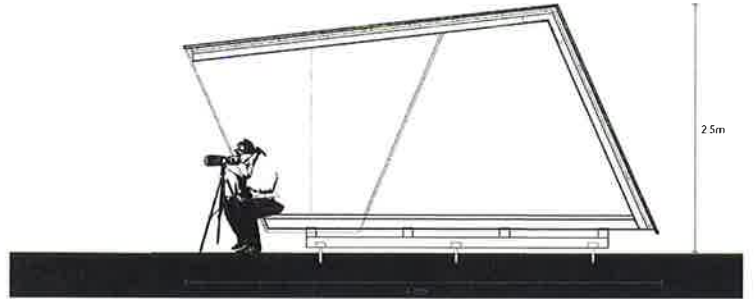



FJORDS 2: BREAKWATER WINDSHELTER

Closest to the centre of Øksfjord, this gapahuk is located on a completely unique breakwater point. It has great potential to act as a gathering place, ideal for barbeques or small communal events. These qualities make it particularly valuable for locals in the area.

The structure is large and diverse

enough to allow a number of small groups to enjoy it simultaneously. Fire pits distinguish at least three separate seating zones.

It also includes a protected space where visitors (or locals) can overnight. Offering a sense of escape to users while maintaining a strong connection to all the comforts that Øksfjord has to offer.

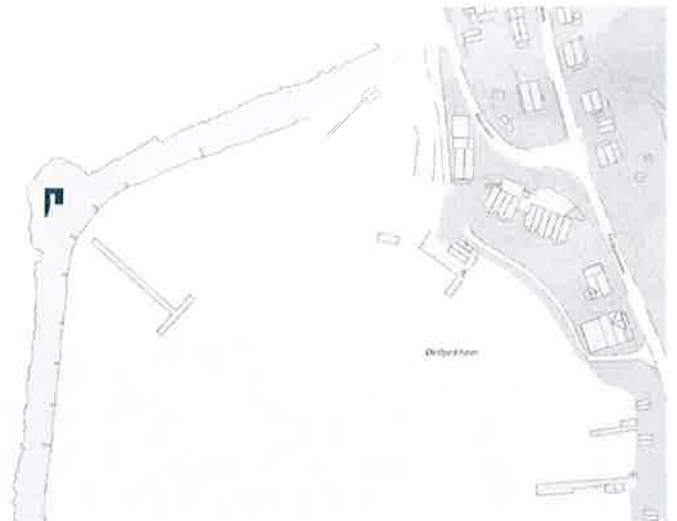
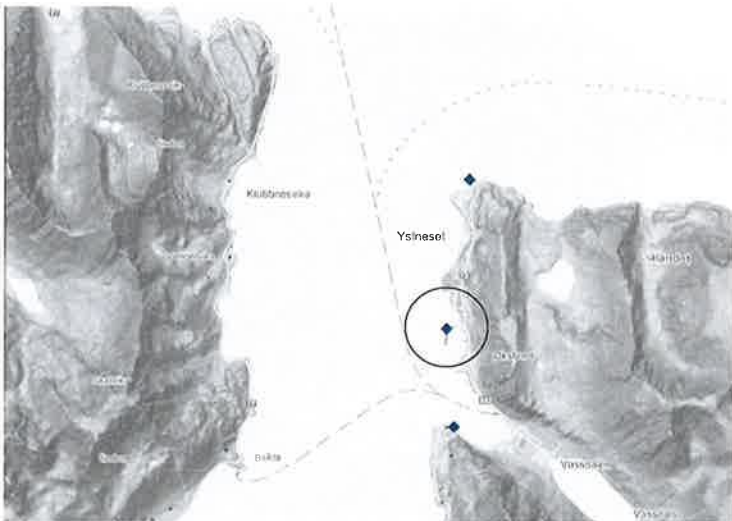
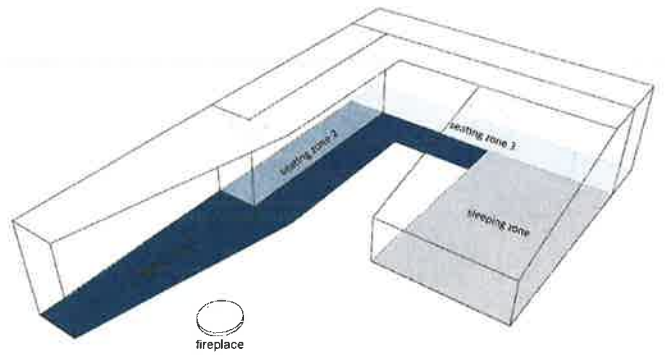



view towards Øksfjord harbor and breakwater project site, with Finnmark alps in the background

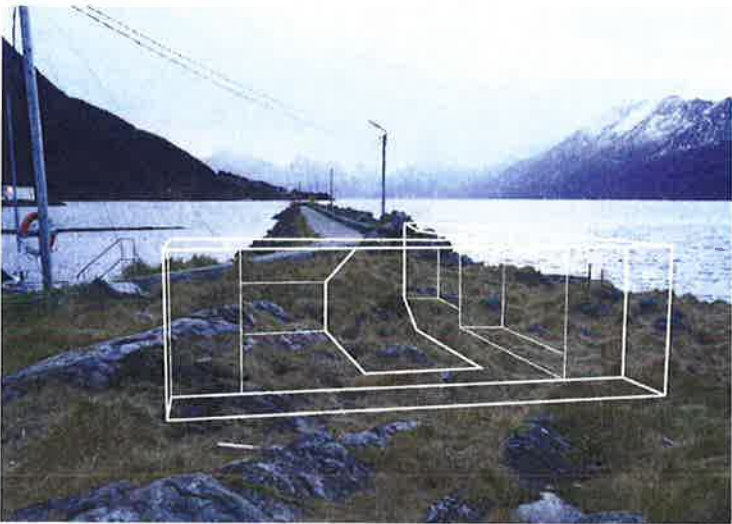
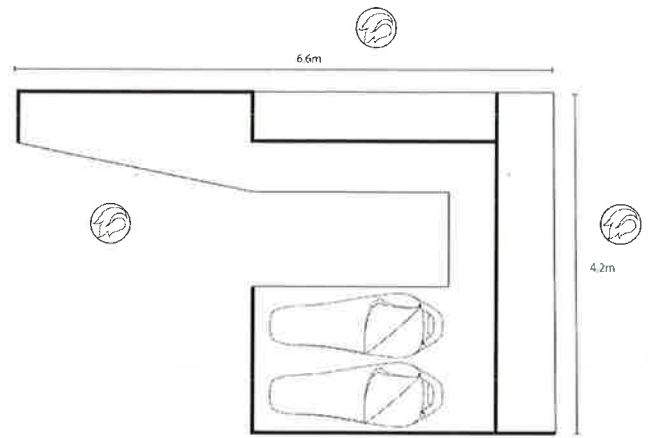
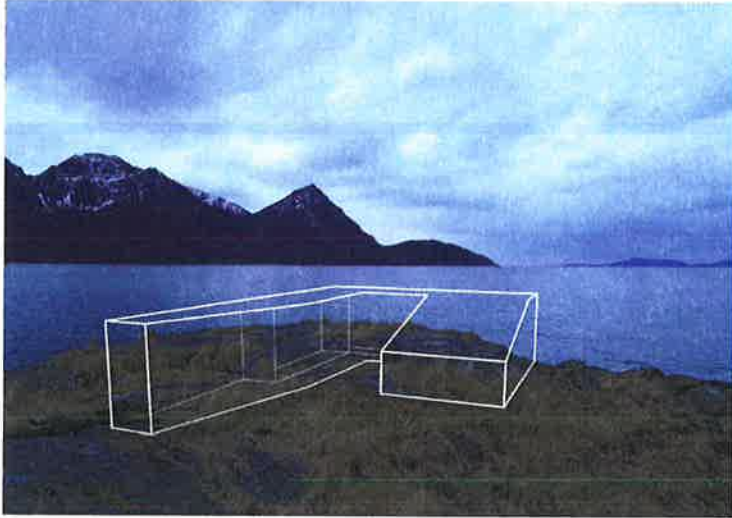

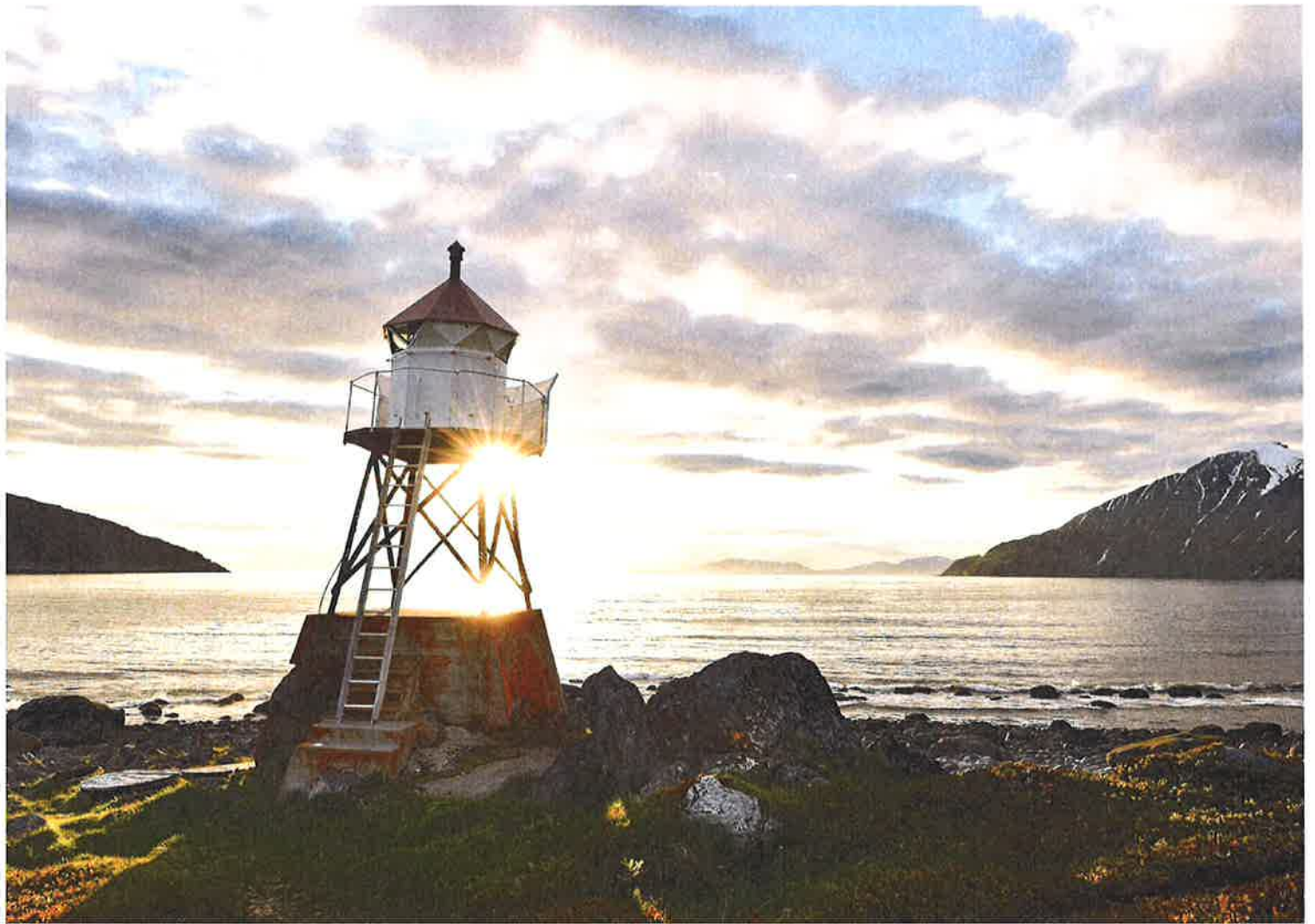

FJORDS 3: NORTHPOINT WINDSHELTER

With a direct and dramatic view north, this endpoint gapahuk lets users feel a sense of real seclusion and escape just minutes out of town.

the opportunity for multiple groups to enjoy the structure at once.

With a built in barbeque area, this gapahuk is focused on being a gathering place for locals. Three separate seating areas offer

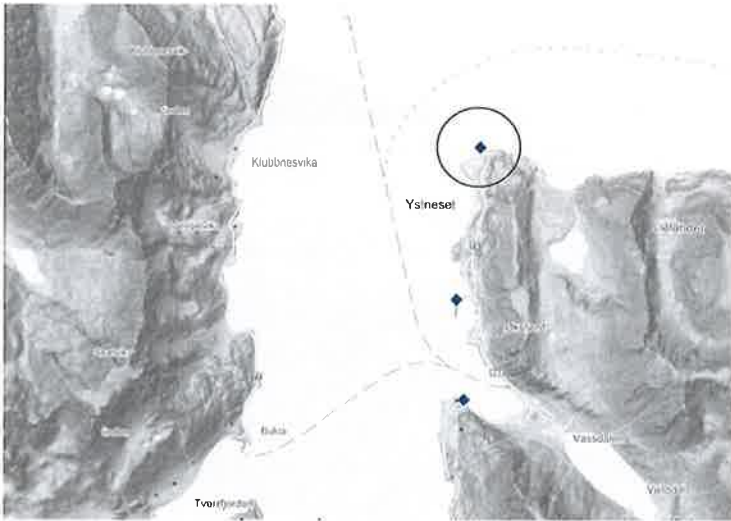
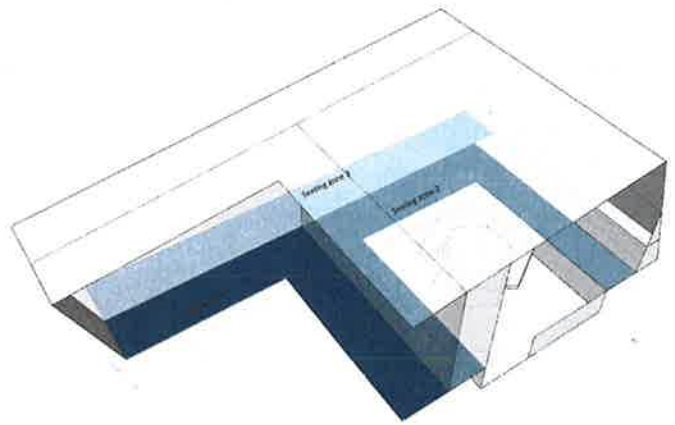



view over project site looking north and towards Hella

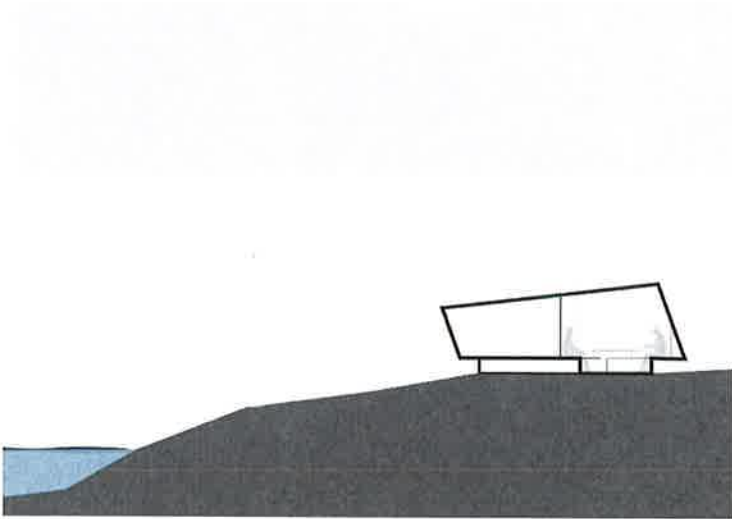
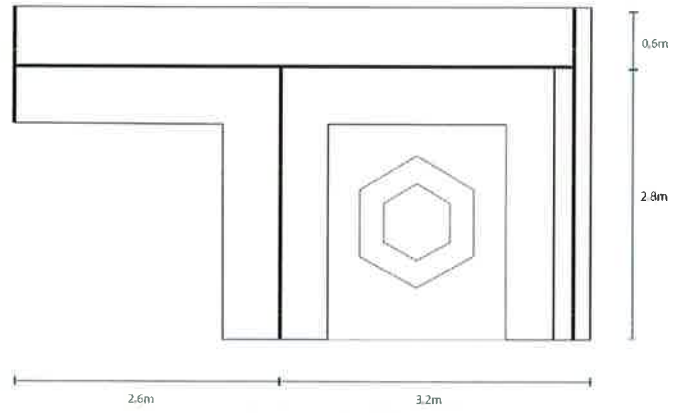

 Grasdalsvatnet
Rássejávri 1,0 km

  Øksfjordfjellet
Stuibmehårji 1,3 km



view towards Øksfjord and Finnmark alps from project site

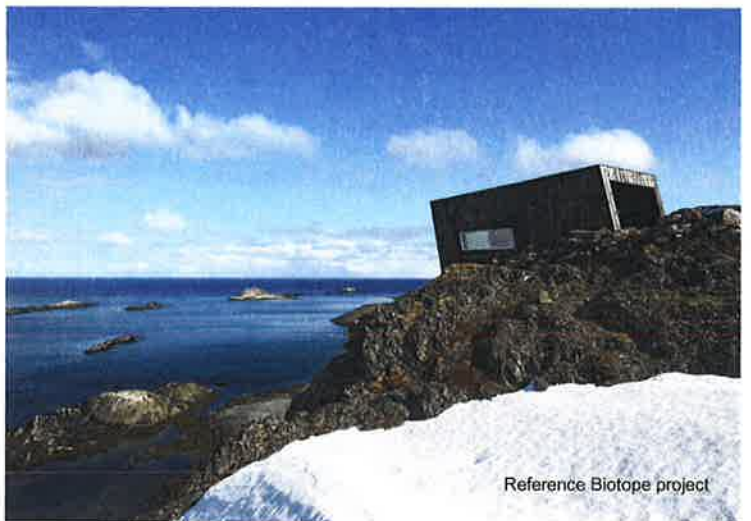
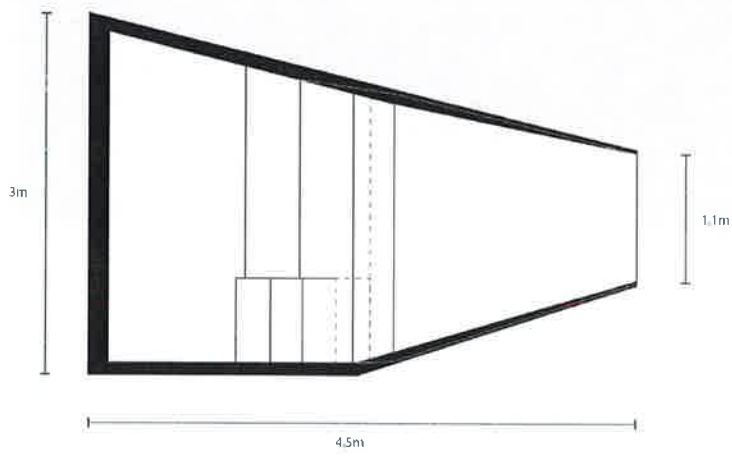
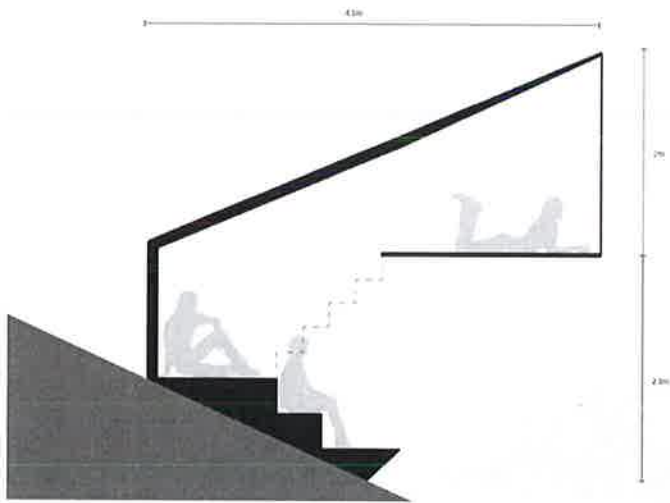

Reference Biotope project



MOUNTAINS 2: VASSDAL'S BIVOUAC

As a Perletur route, this hiking trail is already receiving attention and maintenance. and take the trips up and down on different days.

Summiting at 678m, this is one of the highest points directly accessible to hikers from Øksfjord. This means it offers hikers a challenge without the need for extra boat or car rides.

Because of the challenging nature of the route, a bivouac is conceptualised which offers hikers the opportunity to overnight,

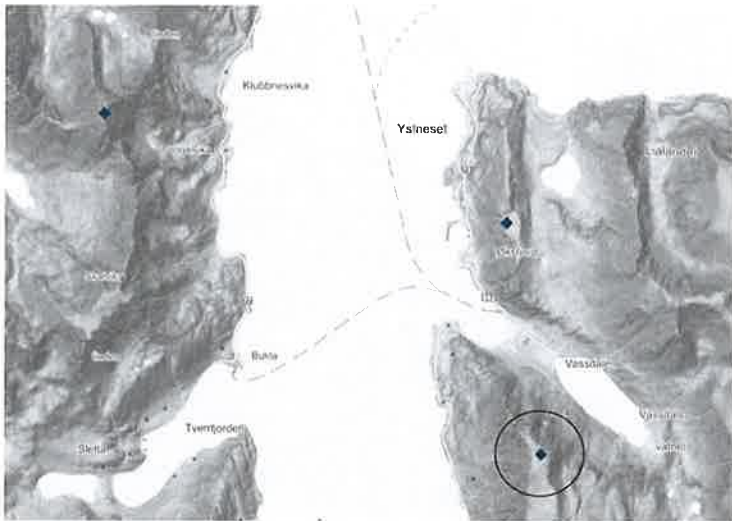
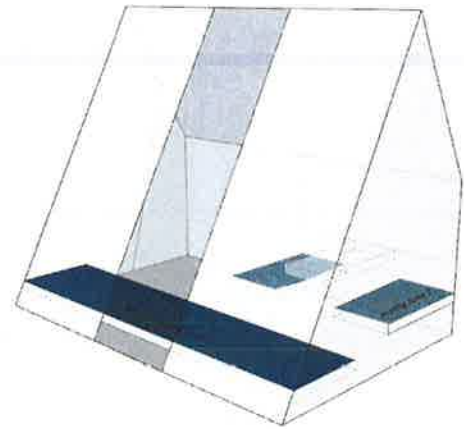

view north towards
Øksfjord from project
site
Picture: Ståle
Sæther



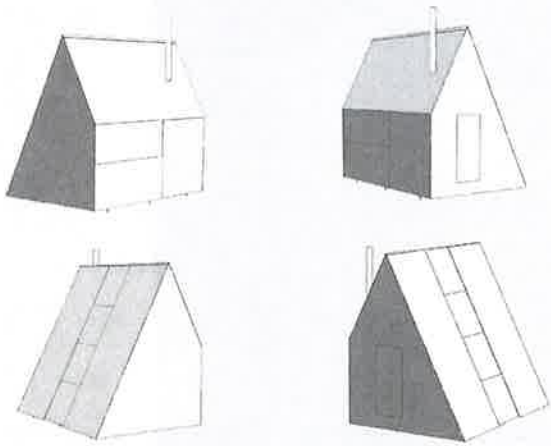
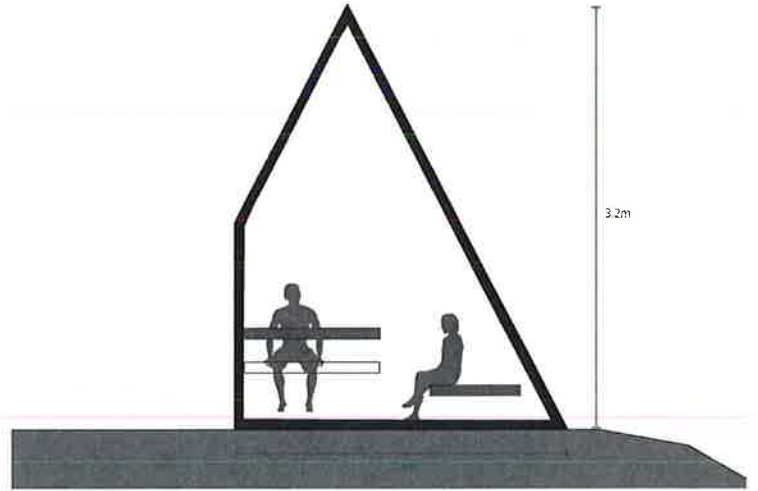



MOUNTAINS 3: THE RIDGE BIVOUAC

This iconic ridge walk summits three peaks. Hikers can begin their route from either Klubbnesvika or Sletta, and climb Klubbnesviktinden, Sommersettinden and Skatviktinden.

As the central peak, Sommersettinden will play host to the bivouac. This will offer hikers a place to rest or stay the night, with impressive views over the surrounding mountains and fjords, looking directly over Øksfjord.

To reach this hiking route, a boat service will be needed to transport passengers to and from the area.

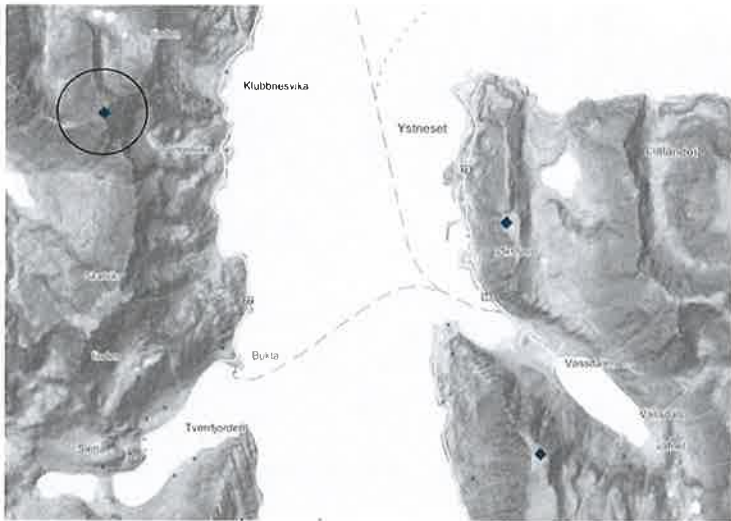
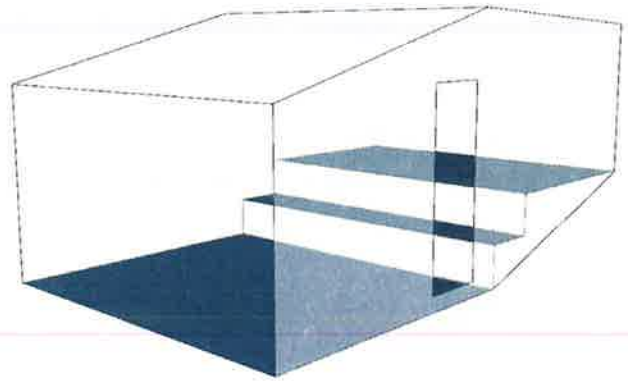



view towards project site, hiking route marked over three ridges Klubbnesviktinden, Sommersettinden and Skatviktinden

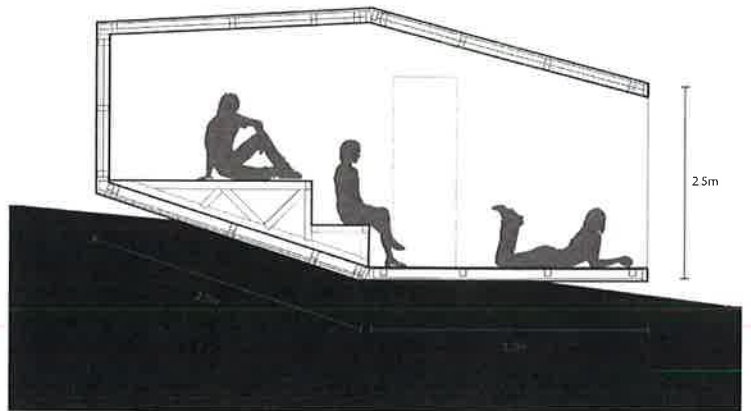

TRANSPORT LOGISTICS

A total of 5 shelters will need to be transported and placed with helicopter. Each of these structures will be designed to accommodate the technical requirements of this transport.

Combining the placement of multiple structures on the same day is the most efficient approach, as the largest amount of the time and costs are from flying the helicopter to location from Alta.

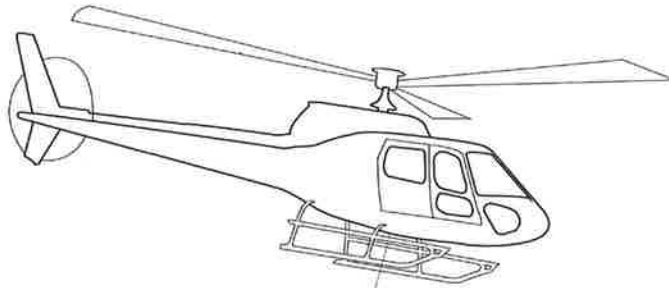

*PRICE ESTIMATES
assuming 2 trips for each structure*

Individually

Øksfjordfjellet: 27,400 NOK
Sommersettinden: 31,150 NOK
Vassdalstinden: 27,400 NOK

*Svartfjellet: 35,650 NOK
*Kollarentinden: 27,400 NOK

Combined

Øksfjord 3: 64,900 NOK

*Bergsfjord 2: 52,400 NOK

**the Bergsfjord structures will first have to be moved to a location closer than Øksfjord to be transported by helicopter.*

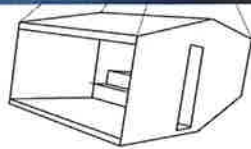



Bergsfjord area hiking map

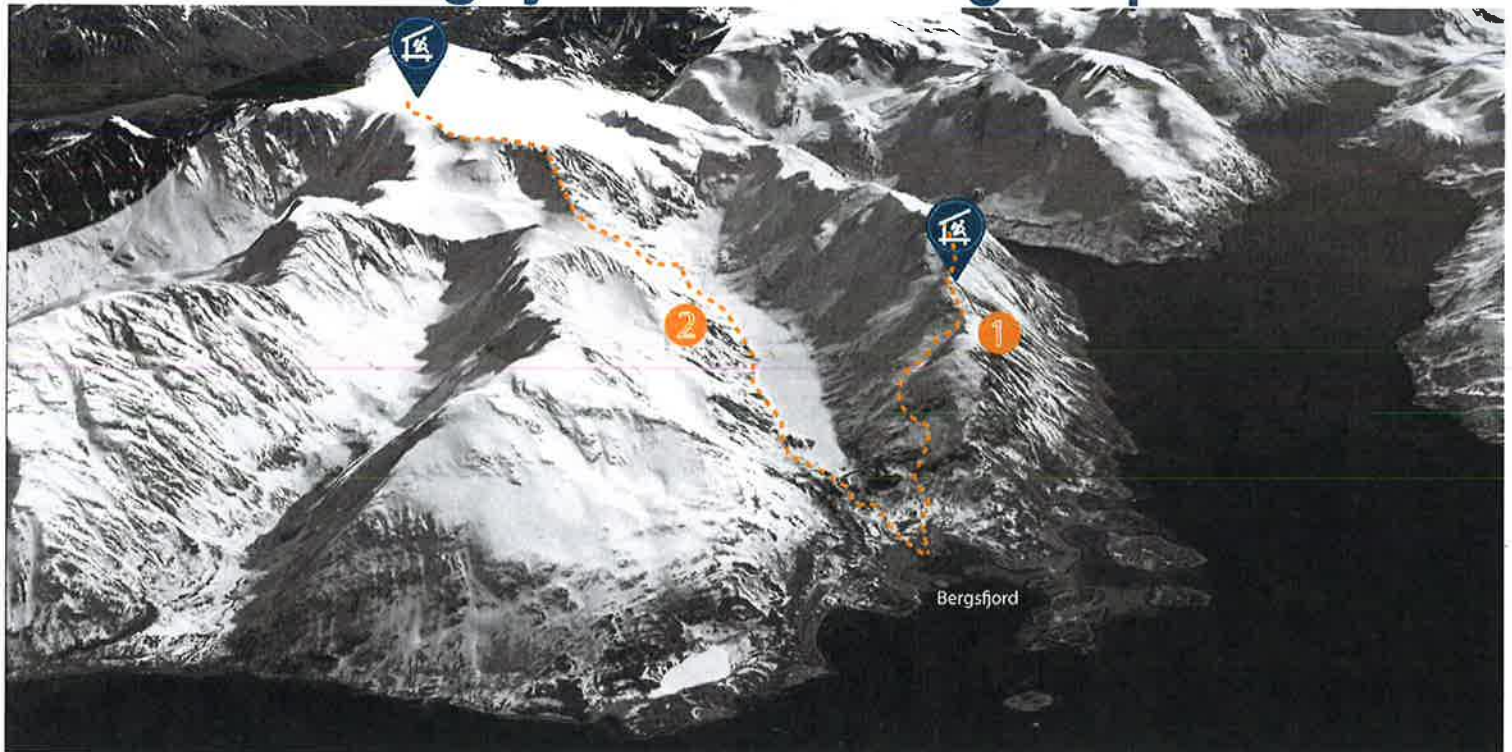

1 Kollaren

Perletur route
summit 625m
medium difficult
directly accesible from Bergsfjord

2 Svartfjelljøkelen

summit 1067m
difficult
directly accesible from Bergsfjord

KOLLAREN SUMMIT WINDSHELTER

Following a boat trip to Bergsfjord, visitors may choose between a number of hikes offered in the area.

The kollaren hiking route is 2.3 km long with some steep inclines and a duration of about two hours. The gapahuk, positioned not at the summit, but at the plateau, offers hikers a place to rest along the route. At 600m above sea level, this point still boasts impressive panoramic views.

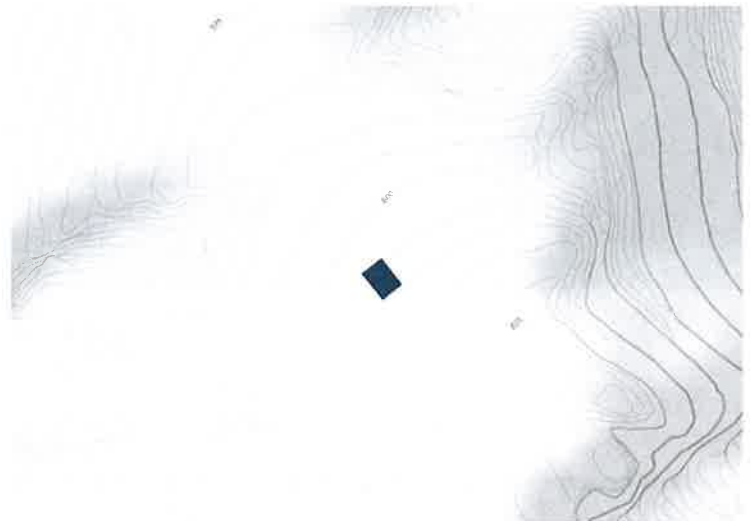
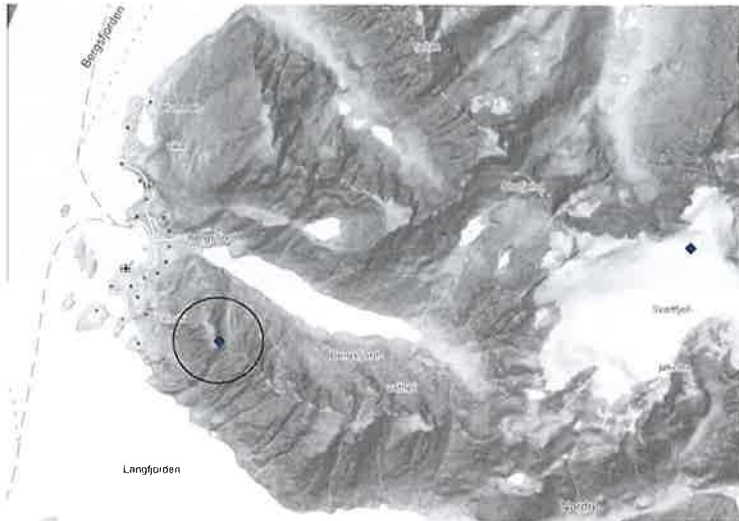



view towards Bergsfjord and the project site: top of Kollaren mountain, on the right

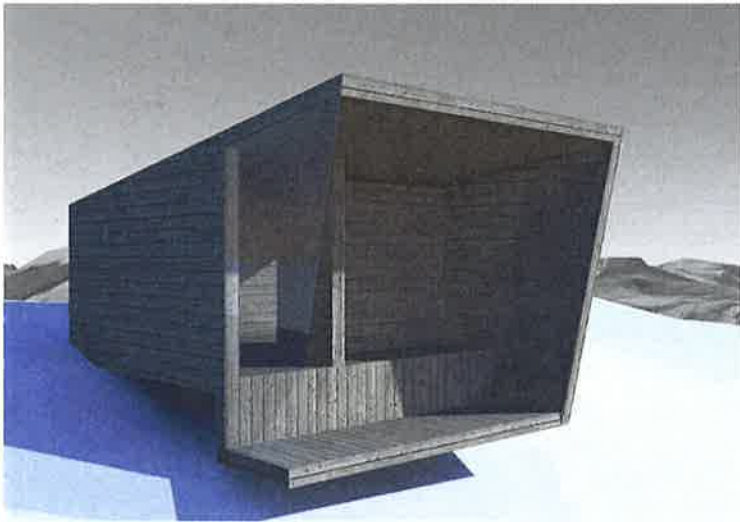
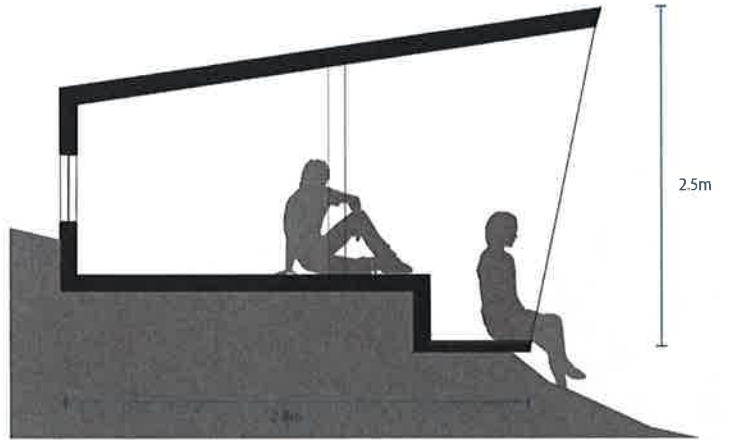
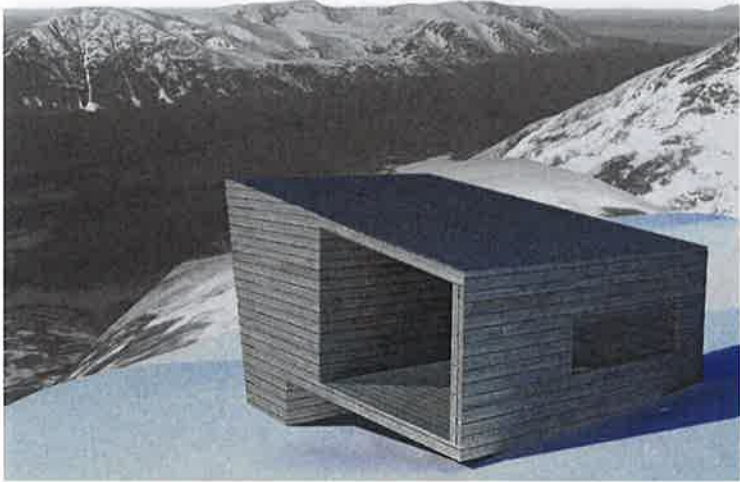



THE GLACIER BASE STATION

Unlike anything before it, this final gapahuk in the collection is truly a one of a kind experience.

With majestic views over the Finnmark alps, this bivouac sits on top of the Svartfjelljokelen (glacier). The most remote of the architectural layouts, this bivouac acts as a base station for more energetic hikers that are looking for an extremely remote and exclusive nature experience.

The bivouac sleeps 4-6 and is accessible through two doors, in case of snow blockage.

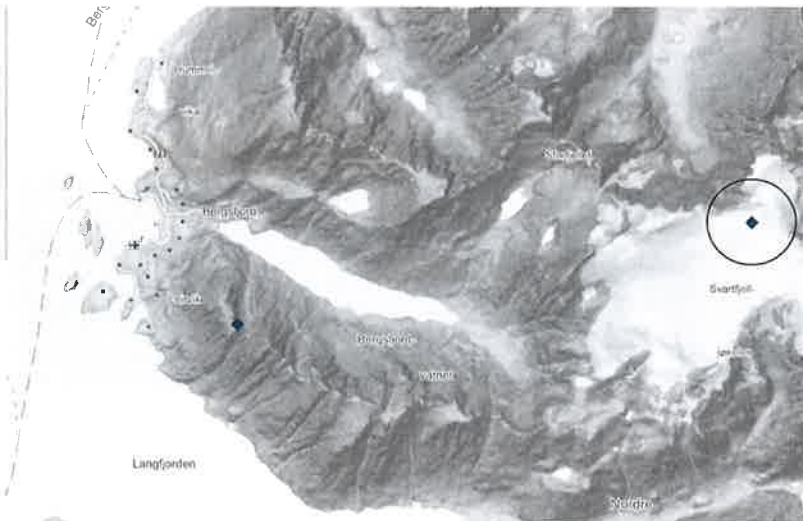
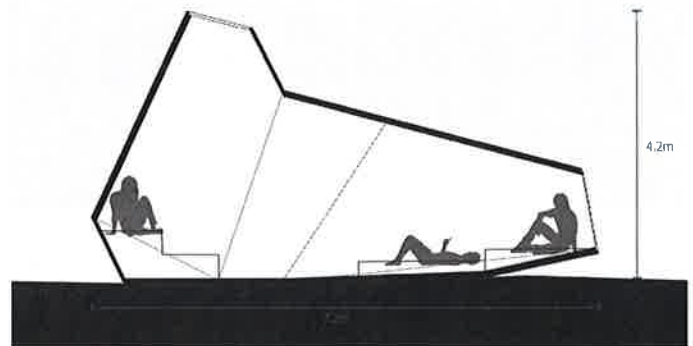
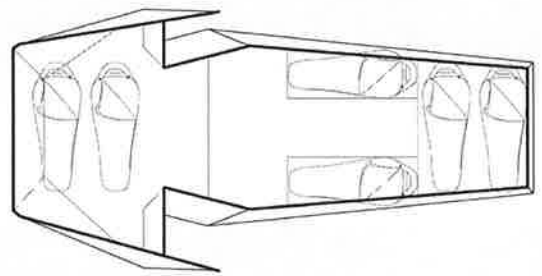
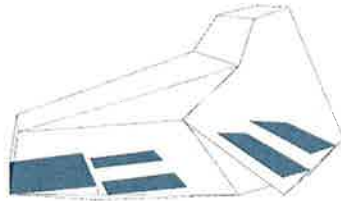





biotope
ARCHITECTURE & NATURE



